

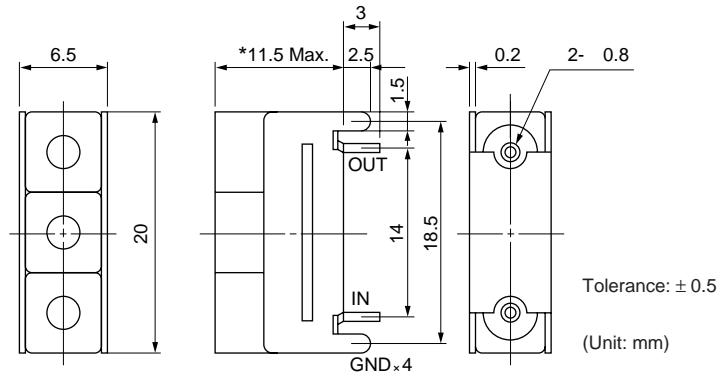

### TYPE 6DFB (3 Pole Type)

Frequency Range: 800~1700MHz

Temperature Range: -40°C~+85°C

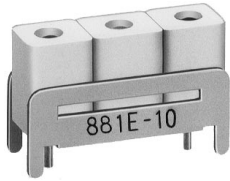

\*: Depends on Center Frequency.  
\*: 高さは周波数に依存します。

#### Measurement values: 6DFB-881E-10

Passband Insertion Loss	1.51dB
Passband Ripple	0.37dB
Passband V.S.W.R.	1.48
Attenuation at 849MHz	18.5dB
at 914MHz	18.7dB

#### Characteristics 特性曲線

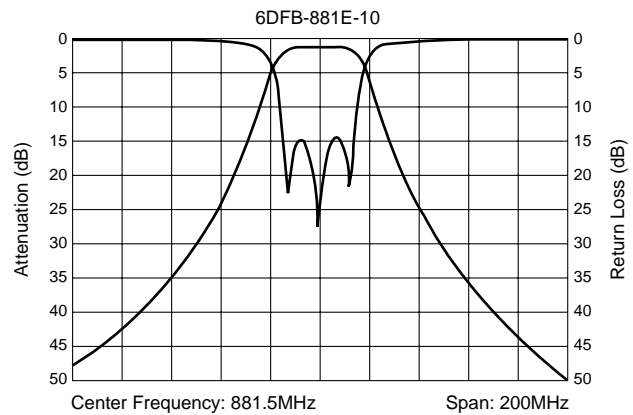

### SELECTION GUIDE FOR STANDARD DEVICES

The Part Numbers shown in the table below are standard devices, which are readily available. TOKO will design and manufacture modified and custom devices with specific characteristics to meet your requirements. If you do not find the device for your application in this catalog, please contact our sales or representative office.

下記の表に示す製品番号は、標準品です。TOKOは、お客様のご要望に合わせ設計、製作いたしますので、お客様の用途に適合する仕様が見当たらない場合は、当社営業所または代理店にご連絡ください。

#### TYPE 6DFB: 3 Pole Designs

東光品番	中心周波数	帯域幅	挿入損失	帯域内リップル	V.S.W.R.	選択度	応用例
TOKO Part Number	Center Freq. (MHz)	Bandwidth (fo ± MHz)	Insertion Loss (dB) max.	Ripple in BW (dB) max.	V.S.W.R. in BW max.	Selectivity (dB) min. (MHz)	Application
6DFB-836E-10	836.5	± 12.5	2.0	0.8	2.0	12 (fo ± 32.5)	Cellular-AMPS
6DFB-881E-10	881.5	± 12.5	2.0	0.8	2.0	12 (fo ± 32.5)	Cellular-AMPS
6DFB-888G-10	888.5	± 16.5	2.5	0.8	2.0	6 (fo ± 28.5)	Cellular-TACS
6DFB-933G-10	933.5	± 16.5	2.5	0.8	2.0	6 (fo ± 28.5)	Cellular-TACS
6DFB-902E-10	902.5	± 12.5	2.0	0.8	2.0	12 (fo ± 32.5)	Cellular-NMT/GSM
6DFB-947E-10	947.5	± 12.5	2.0	0.8	2.0	12 (fo ± 32.5)	Cellular-NMT/GSM
6DFB-915E-10	915.0	± 13.0	2.0	0.8	2.0	12 (fo ± 32.5)	Spread Spectrum
6DFB-866A-10	866.0	± 2.0	4.5	1.0	2.0	20 (fo ± 16)	CT2
6DFB-886A-10	886.0	± 1.0	4.0	0.5	2.0	45, 50 (fo - 45, + 45)	Cordless Phone
6DFB-931A-10	931.0	± 1.0	4.0	0.5	2.0	45, 50 (fo - 45, + 45)	Cordless Phone
6DFB-914A-10	914.5	± 0.5	4.0	0.5	2.0	45, 50 (fo - 45, + 45)	Cordless Phone
6DFB-959A-10	959.5	± 0.5	4.0	0.5	2.0	45, 50 (fo - 45, + 45)	Cordless Phone
6DFB-1575B-10	1575.4	± 5.0	3.0	1.0	2.0	18 (fo ± 50)	GPS Receiver
6DFB-1544F-10	1544.5	± 14.5	3.0	1.0	2.0	20, 30 (fo - 64.5, + 82)	INMARSAT
6DFB-1643G-11	1643.5	± 17.0	3.0	1.0	2.0	23, 37 (fo - 67, + 108)	INMARSAT
6DFB-1459B-10	1459.0	± 6.0	3.0	1.0	2.0	34, 38 (fo - 67, + 78)	MCA

### TYPE 6DFC (4 Pole Type)

Frequency Range: 800~1500MHz

Temperature Range: -40°C~+85°C

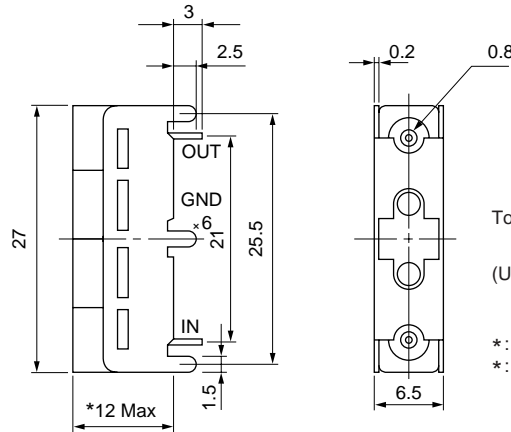
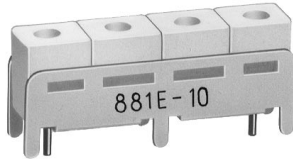

Tolerance: ±0.5

(Unit: mm)

\*: Depends on Center Frequency.  
 \*: 高さは周波数に依存します。

#### Measurement values: 6DFC-881E-10

Passband Insertion Loss	2.15dB
Passband Ripple	0.54dB
Passband V.S.W.R.	1.60
Attenuation	
at 849MHz	28.2dB
at 914MHz	28.0dB

#### Characteristics 特性曲線

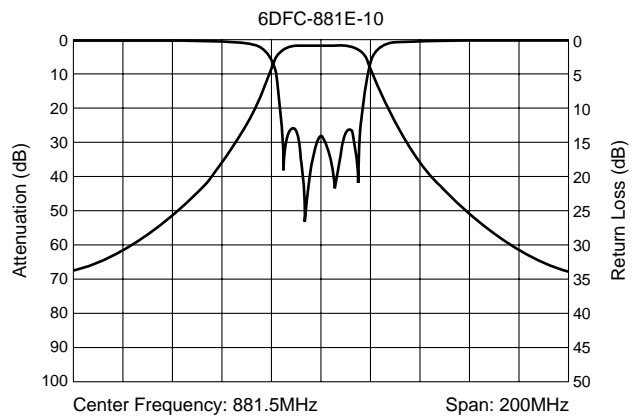

## SELECTION GUIDE FOR STANDARD DEVICES

The Part Numbers shown in the table below are standard devices, which are readily available. TOKO will design and manufacture modified and custom devices with specific characteristics to meet your requirements. If you do not find the device for your application in this catalog, please contact our sales or representative office.

下記の表に示す製品番号は、標準品です。TOKOは、お客様のご要望に合わせて設計、製作いたしますので、お客様の用途に適合する仕様が見当たらない場合は、当社営業所または代理店にご連絡ください。

### TYPE 6DFC: 4 Pole Designs

東光品番	中心周波数	帯域幅	挿入損失	帯域内リップル	V.S.W.R.	選択度	応用例
TOKO Part Number	Center Freq. (MHz)	Bandwidth (fo ± MHz)	Insertion Loss (dB) max.	Ripple in BW (dB) max.	V.S.W.R. in BW max.	Selectivity (dB) min. (MHz)	Application
6DFC-836E-10	836.5	± 12.5	2.7	1.0	2.0	23 (fo ± 32.5)	Cellular-E-AMPS
6DFC-881E-10	881.5	± 12.5	2.7	1.0	2.0	23 (fo ± 32.5)	Cellular-E-AMPS
6DFC-902E-10	902.5	± 12.5	2.7	1.0	2.0	23 (fo ± 32.5)	Cellular-NMT/GSM
6DFC-947E-10	947.5	± 12.5	2.7	1.0	2.0	23 (fo ± 32.5)	Cellular-NMT/GSM
6DFC-1030C-10	1030.0	± 7.5	3.0	1.0	2.0	40, 60 (fo ± 60, ± 120)	TCAS
6DFC-1090C-10	1090.0	± 7.5	3.0	1.0	2.0	40, 60 (fo ± 60, ± 120)	TCAS
6DFC-1229B-12TW	1229.0	± 5.0	4.0	0.6	2.0	35, 33 (fo - 36, + 36)	CATV
6DFC-1553I-10	1553.25	± 23.25	3.0	1.0	2.0	25 (fo ± 73.25)	Satellite
6DFC-1300E-11	1300.0	± 12.5	3.2	0.8	2.0	19 (fo ± 36)	CATV

### TYPE 6DFSC (4 Pole Type)

Frequency Range: 800~1500MHz

Temperature Range: -40°C~+85°C

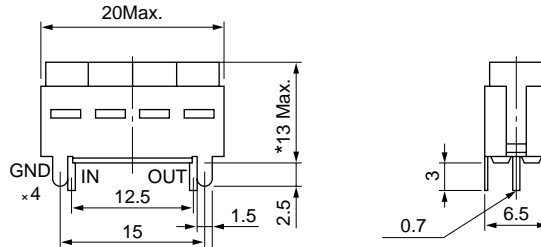

Tolerance: ±0.5

(Unit: mm)

\*: Depends on Center Frequency.  
\*: 高さは周波数に依存します。

### Characteristics 特性曲線

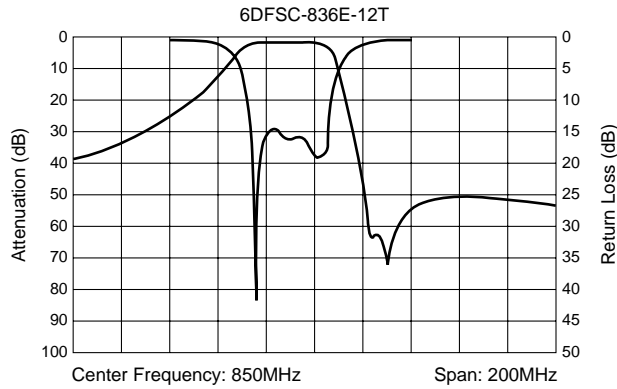

### SELECTION GUIDE FOR STANDARD DEVICES

The Part Numbers shown in the table below are standard devices, which are readily available. TOKO will design and manufacture modified and custom devices with specific characteristics to meet your requirements. If you do not find the device for your application in this catalog, please contact our sales or representative office.

下記の表に示す製品番号は、標準品です。TOKOは、お客様のご要望に合わせ設計、製作いたしますので、お客様の用途に適合する仕様が見当たらない場合は、当社営業所または代理店にご連絡ください。

#### TYPE 6DFSC: 4 Pole Designs

東光品番	中心周波数	帯域幅	挿入損失	帯域内リップル	V.S.W.R.	選択度
TOKO Part Number	Center Freq. (MHz)	Bandwidth (fo ± MHz)	Insertion Loss in BW (dB) max.	Ripple in BW (dB) max.	V.S.W.R. in BW max.	Selectivity (dB) min. (MHz)
6DFSC-836E-12T	836.5	± 12.5	2.5	0.9	1.7	43 (869~894)
6DFSC-920C-10	920.0	± 7.0	4.0	1.2	2.0	40 (fo ± 53)

Note: The 6DFSC-836E-12T is for use at the Tx (Transmit side) of the 6DPK-836E881E-12T.

注: 6DFSC-836E-12Tは6DPK-836E881E-12TのTx側を構成するものです。

### TYPE 6DFD (5 Pole Type)

Frequency Range: 800~1500MHz

Temperature Range: -40°C~+85°C

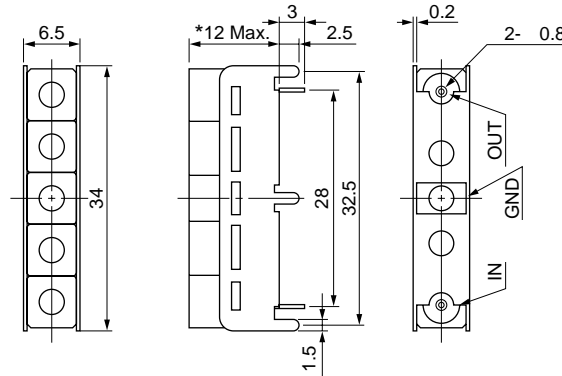
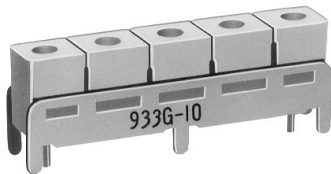

Tolerance: ± 0.5

(Unit: mm)

\*: Depends on Center Frequency.  
 \*: 高さは周波数に依存します。

#### Measurement values: 6DFD-933G-10

Passband Insertion Loss	2.25dB
Passband Ripple	0.57dB
Passband V.S.W.R.	1.58
Attenuation at 905MHz	14.2dB
Attenuation at 962MHz	16.6dB

#### Characteristics 特性曲線

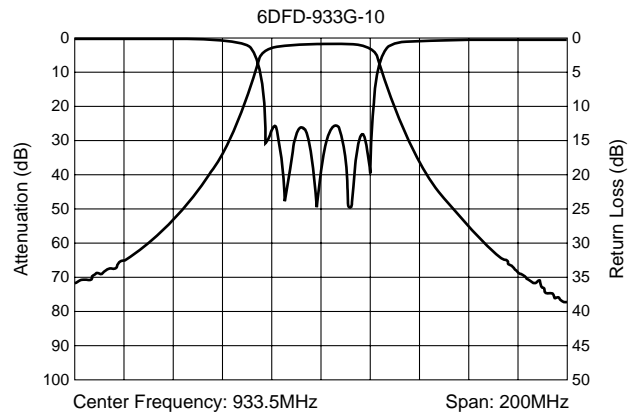

## SELECTION GUIDE FOR STANDARD DEVICES

The Part Numbers shown in the table below are standard devices, which are readily available. TOKO will design and manufacture modified and custom devices with specific characteristics to meet your requirements. If you do not find the device for your application in this catalog, please contact our sales or representative office.

下記の表に示す製品番号は、標準品です。TOKOは、お客様のご要望に合わせて設計、製作いたしますので、お客様の用途に適合する仕様が見当たらない場合は、当社営業所または代理店にご連絡ください。

### TYPE 6DFD: 5 Pole Designs

東光品番	中心周波数	帯域幅	挿入損失	帯域内リップル	V.S.W.R.	選択度	応用例
TOKO Part Number	Center Freq. (MHz)	Bandwidth (fo ± MHz)	Insertion Loss in BW (dB) max.	Ripple in BW (dB) max.	V.S.W.R. in BW max.	Selectivity (dB) min. (MHz)	Application
6DFD-933G-10	933.5	± 16.5	3.0	1.0	2.0	11 (fo ± 28.5)	Cellular
6DFD-1542G-10	1542.0	± 17.0	4.0	1.5	2.0	45 (fo ± 84.5)	Inmarsat

### TYPE 6DFSD (5 Pole Type)

Frequency Range: 800~1500MHz

Temperature Range: -40°C~+85°C

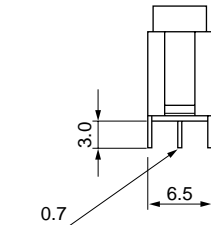
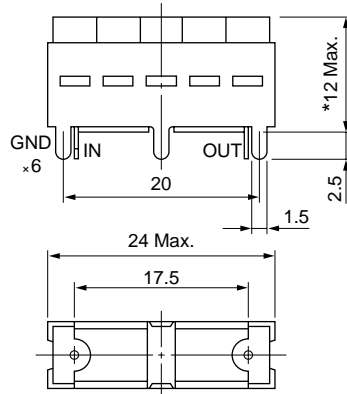
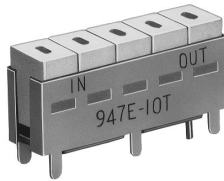

Tolerance: ± 0.5

(Unit: mm)

\*: Depends on Center Frequency.  
\*: 高さは周波数に依存します。

### Characteristics 特性曲線

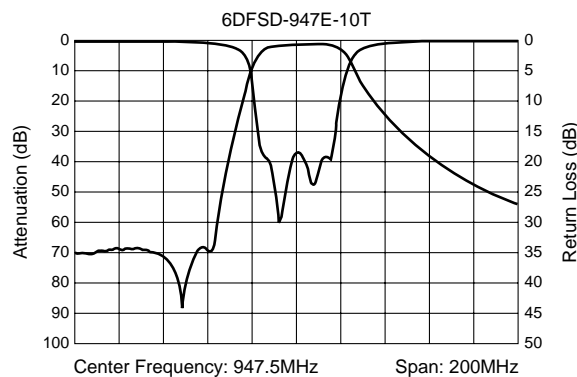

## SELECTION GUIDE FOR STANDARD DEVICES

The Part Numbers shown in the table below are standard devices, which are readily available. TOKO will design and manufacture modified and custom devices with specific characteristics to meet your requirements. If you do not find the device for your application in this catalog, please contact our sales or representative office.

下記の表に示す製品番号は、標準品です。TOKOは、お客様のご要望に合わせ設計、製作いたしますので、お客様の用途に適合する仕様が見当たらない場合は、当社営業所または代理店にご連絡ください。

### TYPE 6DFSD: 5 Pole Designs

東光品番	中心周波数	帯域幅	挿入損失	帯域内リップル	V.S.W.R.	選択度	応用例
TOKO Part Number	Center Freq. (MHz)	Bandwidth (fo ± MHz)	Insertion Loss (dB) max.	Ripple in BW (dB) max.	V.S.W.R. in BW max.	Selectivity (dB) min. (MHz)	Application
6DFSD-881E-10	881.5	± 12.5	3.5	1.2	2.0	24 (fo ± 32.5)	Cellular-E-AMPS
6DFSD-881E-12T	881.5	± 12.5	3.5	1.2	1.7	52 (824-849)	Cellular-E-AMPS
6DFSD-902E-10	902.5	± 12.5	3.5	1.2	1.7	25 (fo ± 32.5)	Cellular-NMT/GSM
6DFSD-947E-11	947.5	± 12.5	3.5	1.2	1.7	25 (fo ± 32.5)	Cellular-NMT/GSM
6DFSD-947E-10T	947.5	± 12.5	3.5	1.5	1.9	53 (890-915)	Cellular-NMT/GSM
6DFSD-1030C-10	1030.0	± 7.5	3.0	0.7	2.0	60 (fo + 60)	TCAS
6DFSD-1090C-10	1090.0	± 7.5	3.5	1.0	2.0	60 (fo - 60)	TCAS

Notes: 1. The letter "T" added to the TOKO number indicates the attachment of a trap.  
2. 6DFSD-881E-12T is for the structure of the 6DPK-836E881E-12T at the Rx (Receive side).

注: 1. 東光品番の最後に付加されているTはトラップ付きを表わします。  
2. 6DFSD-881E-12Tは6DPK-836E881E-12TのRx側を構成するものです。